

Parts List

D&E-T002-PL-0

Type KS-TO	Model ALL	Parts List No. PL0005	Revision No. 2
-----------------------------	----------------------------	--	---------------------------------

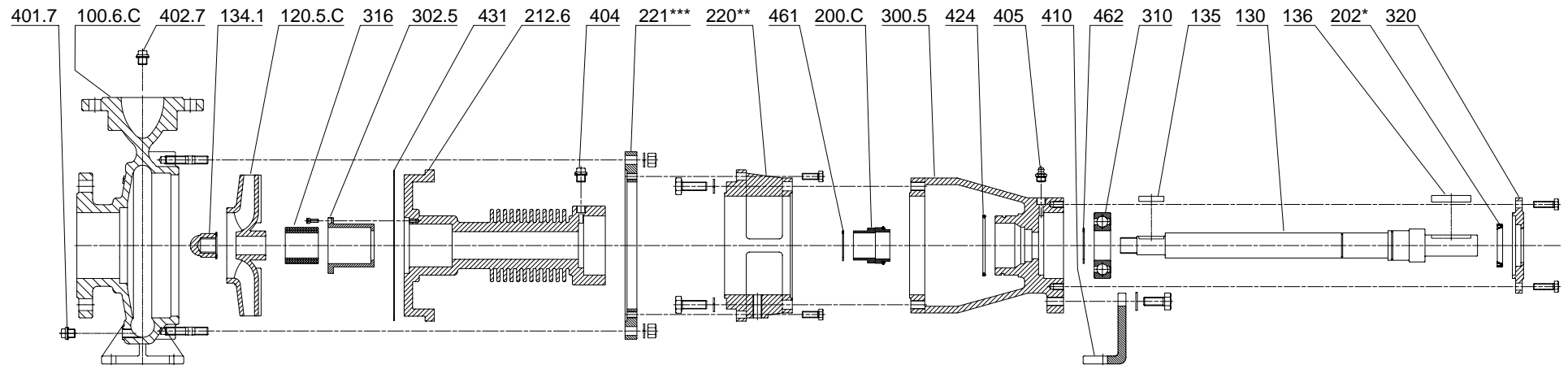

Part No.	Description	Standard Material
100.6.C	Casing for Closed Impeller	Ductile Iron
120.5.C	Closed Impeller	Cast Iron
130	Shaft	Stainless Steel 304
134.1	Impeller Nut	Stainless Steel 304
135	Key for Impeller	Stainless Steel 304
136	Shaft End Key	Stainless Steel 304
200.C	Mechanical Seal	Carbon vs. SiC
202*	V-Seal	Synthetic Rubber
212.6	Stuffing Box Cover	Ductile Iron
220**	Frame Adaptor	Ductile Iron
221***	Adaptor Extension Ring	Cast Iron
300.5	Bearing Frame	Cast Iron
302.5	Sleeve Bearing Housing	Cast Iron
310	Bearing	Steel

Part No.	Description	Standard Material
316	Sleeve Bearing	Synthetic Carbon
320	Bearing Cover	Cast Iron
401.7	Casing Drain Plug	Galvanise Steel
402.7	Venting Plug	Galvanise Steel
404	Oil Plug	Galvanise Steel
405	Grease Nipple	Steel
410	Support Foot	Cast Iron
424	Bearing Frame "O" Ring	Synthetic Rubber
431	Stuffing Box Cover Gasket	Asbestos Sheet
461	Mechanical Seal Cir Clip	Steel
462	Bearing Cir Clip	Steel

* For models 100-260 and 125-260 only.

** For all applicable models except 32-160, 40-160, 50-160, 32-200, 40-200 and 50-200.

*** For all applicable models except 32-160, 40-160, 50-160, 65-160 and 80-160.